

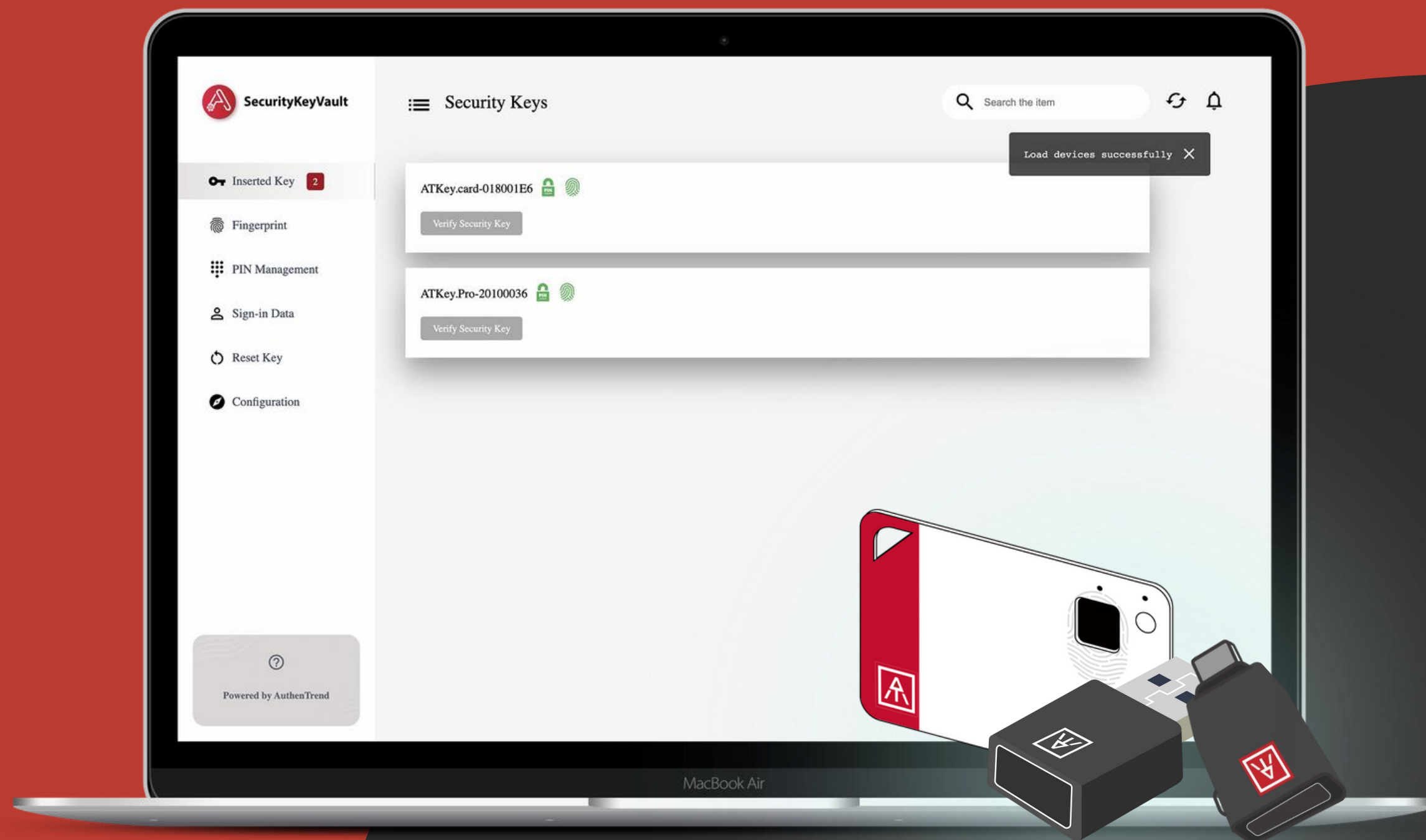



SecurityKeyVault

User Guide

AUTHENTREND



Plug in your FIDO2 security key first

The device will automatically display in "Inserted Key." If not, please click the refresh icon  to reload.

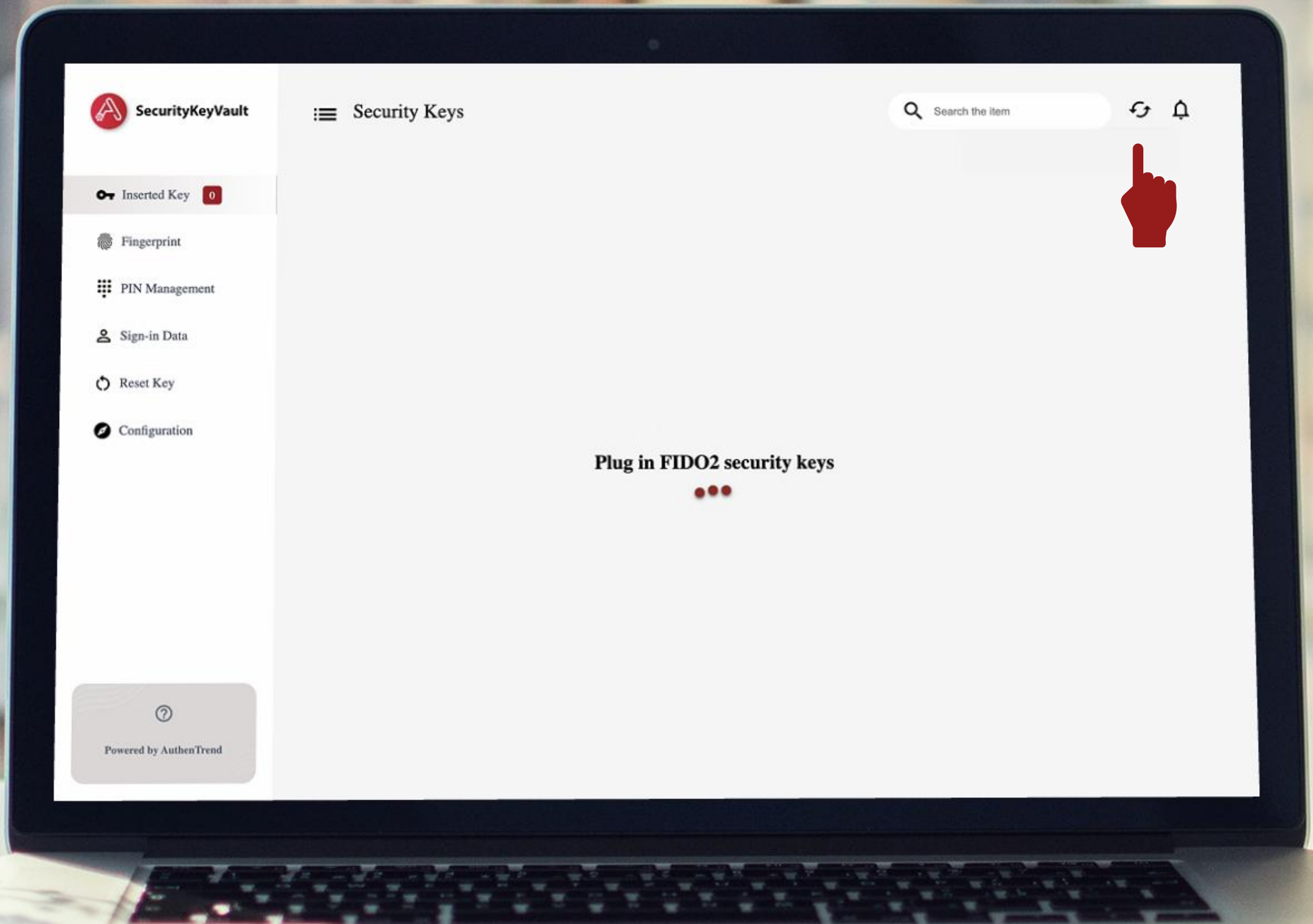

Dashboard

Search for a specific security key

Number of devices
successfully loaded

Sidebar menu

Notifications

Version number

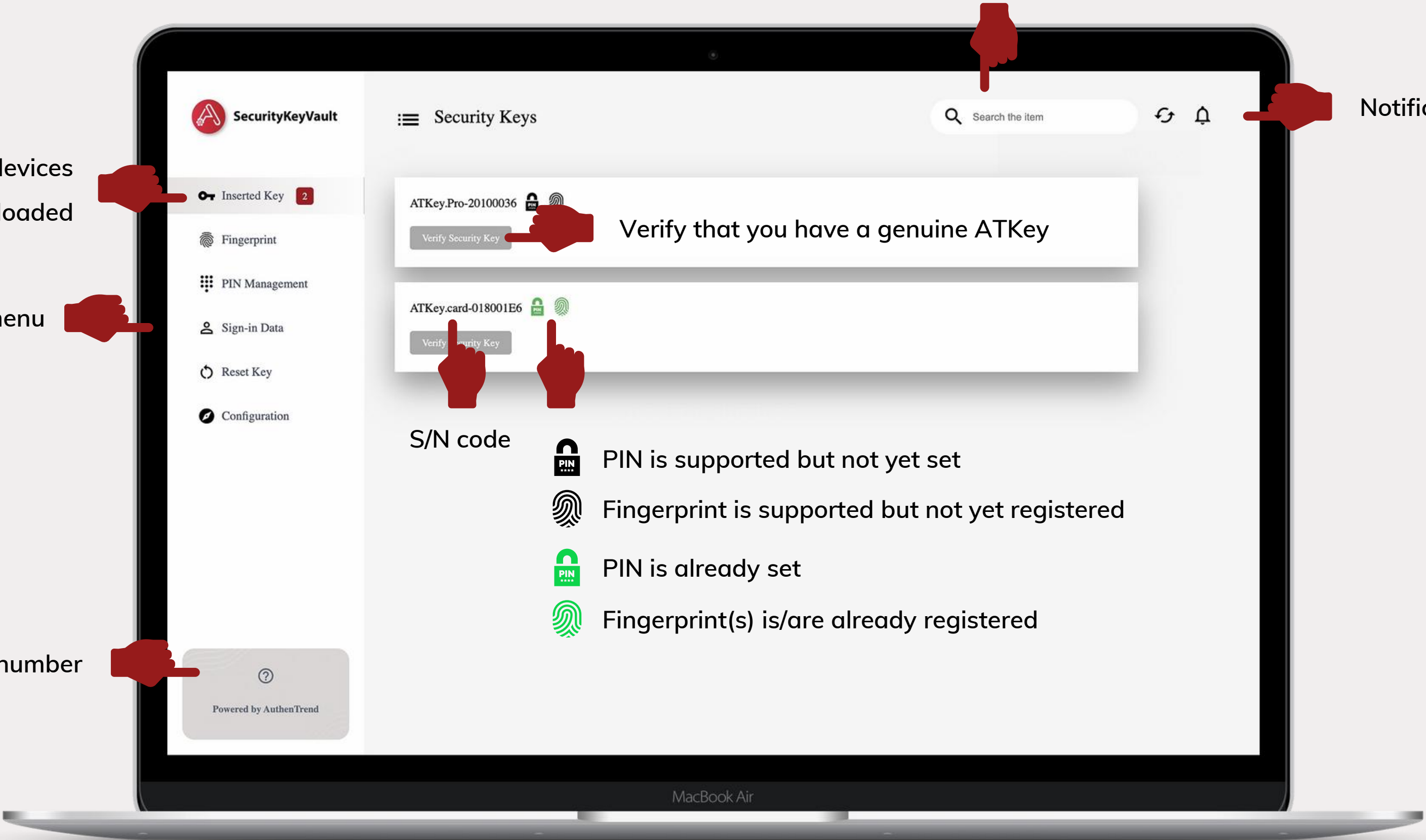

1 Inserted Key

• You can view the PIN and Fingerprint status of each Security Key on this page

• Click "Verify Security Key" to confirm your ATKeys are genuine

Touch or verify your fingerprint after the LED flashes. Security keys of different firmware may have some differences in operation behavior.

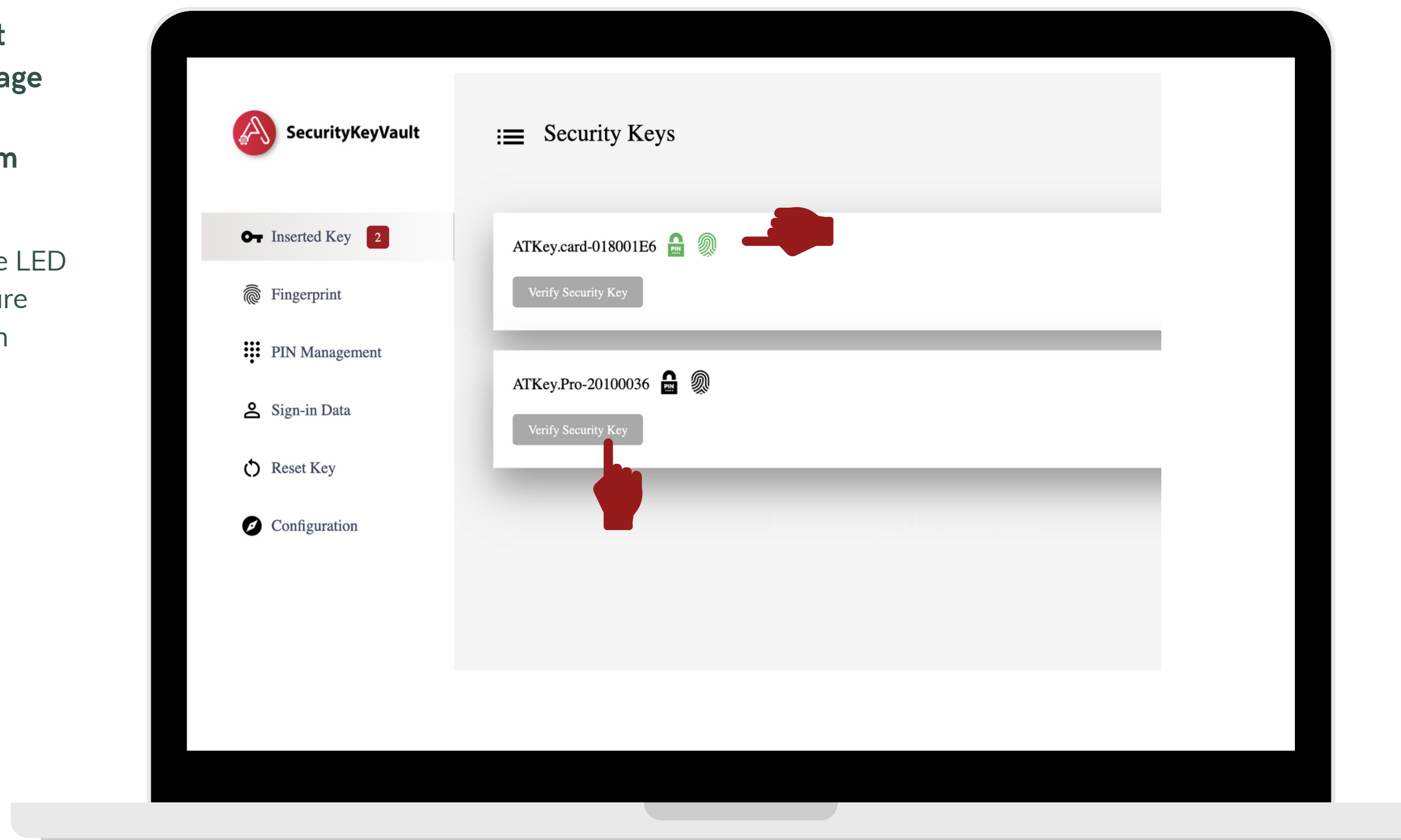

2 Fingerprint -1

• Please note whether the PIN has been set, if not, please set the PIN first before fingerprint enrollment.

• **Select security key:**
Click on the white card to select the device you want to set up, verify your fingerprint or choose to enter the fingerprint management with the PIN.

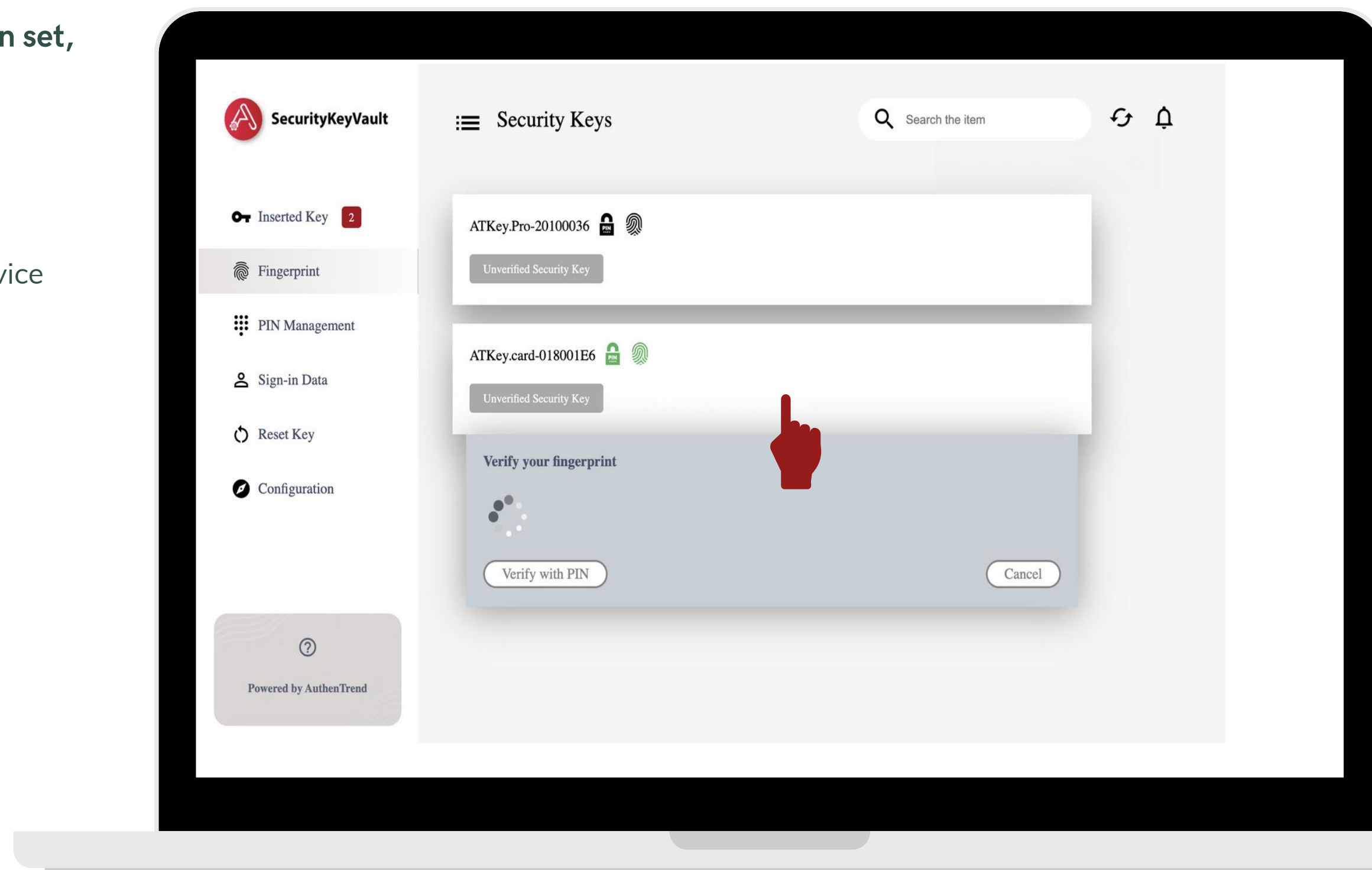

2 Fingerprint -2

+ Add a fingerprint

Follow the instructions to enroll fingerprints.

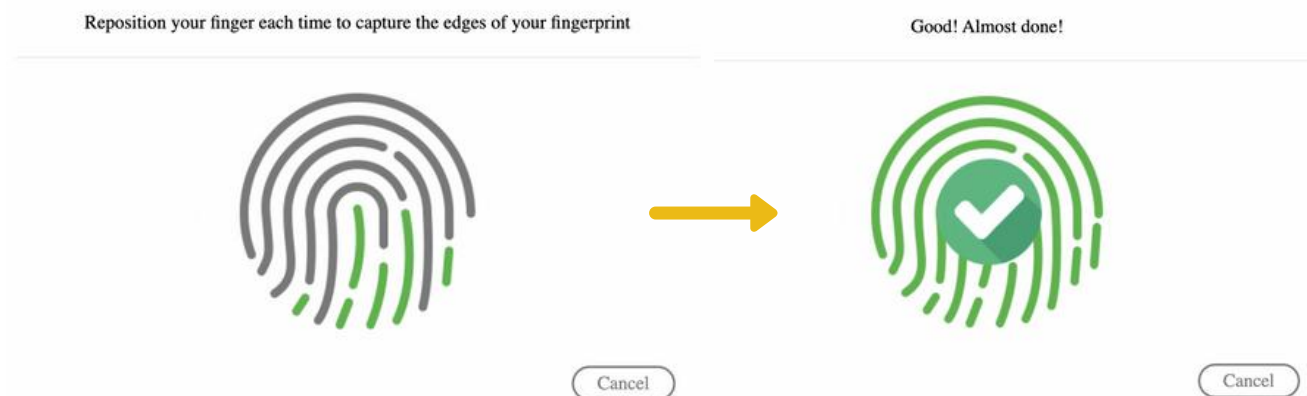

🗑 Delete a fingerprint

• Edit the name of security keys

Double-click the security key to edit the name of device.

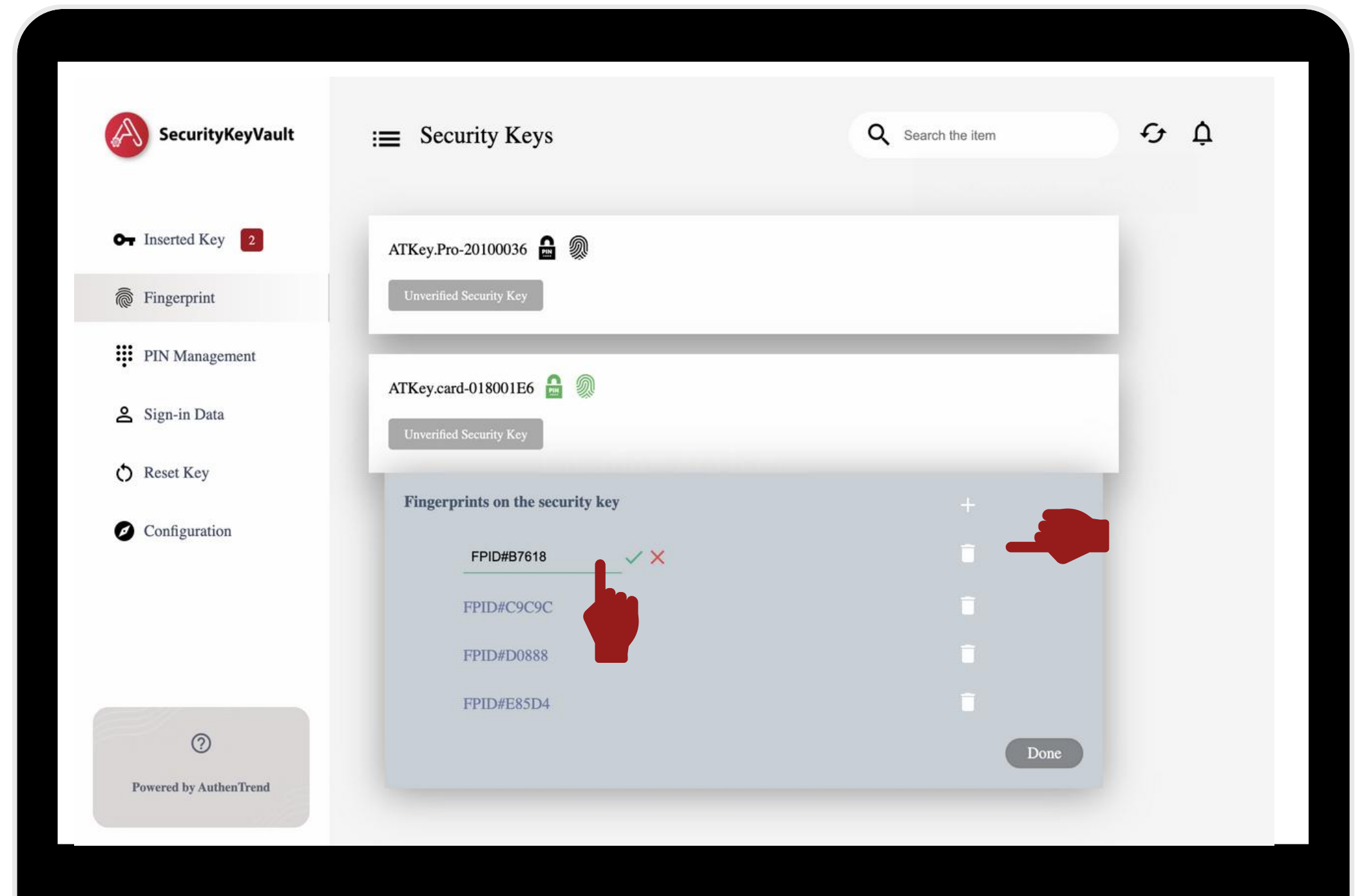

3

PIN Management - General

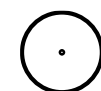

Set a new PIN

Click the white card to set a new PIN

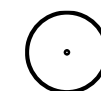
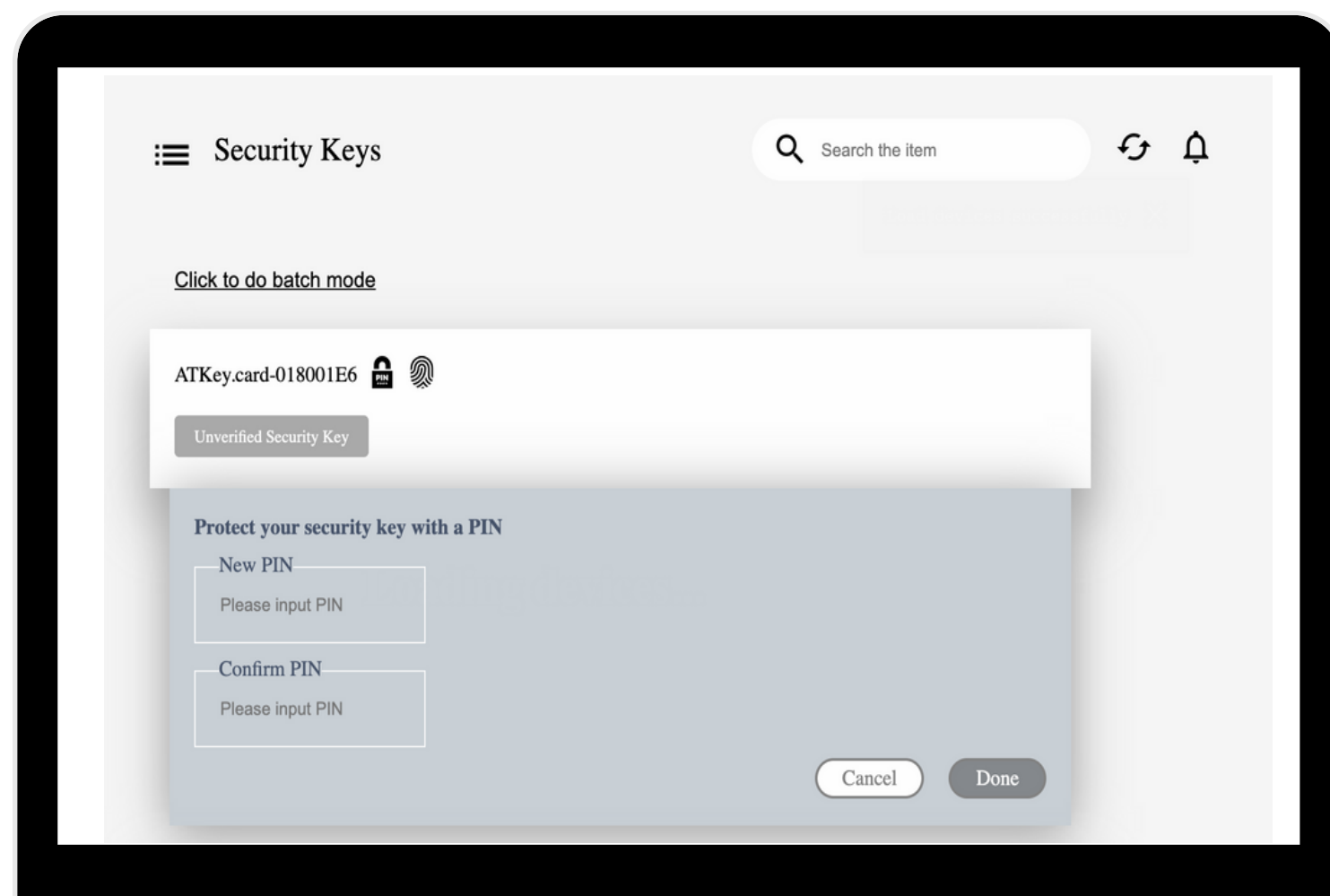

Change PIN

Click the white card to change the PIN, you may need to reset key if you don't remember your existing PIN.

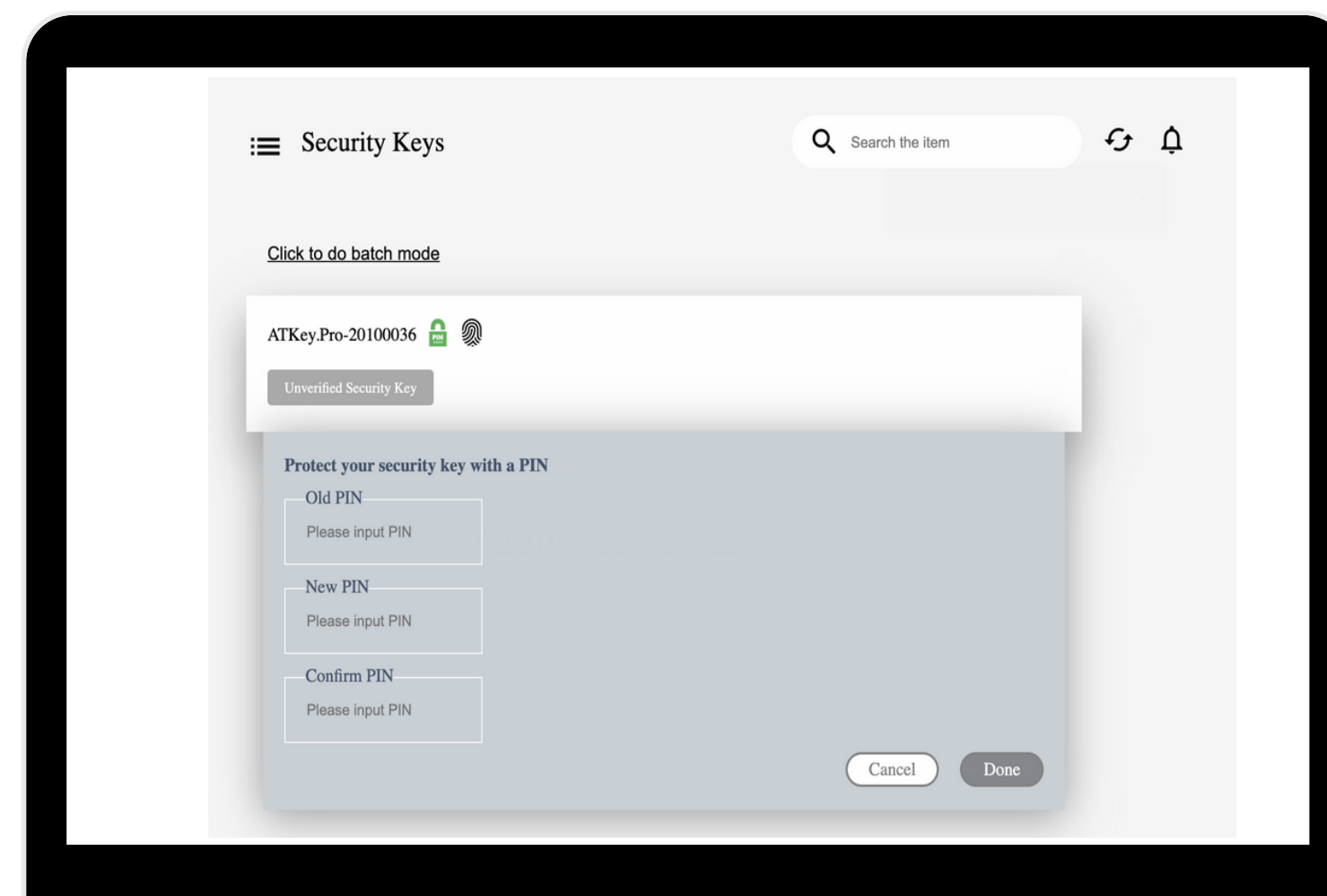

3

PIN Management - Set a PIN for batch security keys

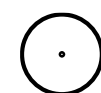

Click to do batch mode → Set PIN

The system will select all devices that are not yet set with a PIN, so if there are some devices that you don't want to be set with the same PIN, please unplug them first.

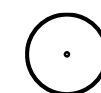

Enter a new PIN and confirm it

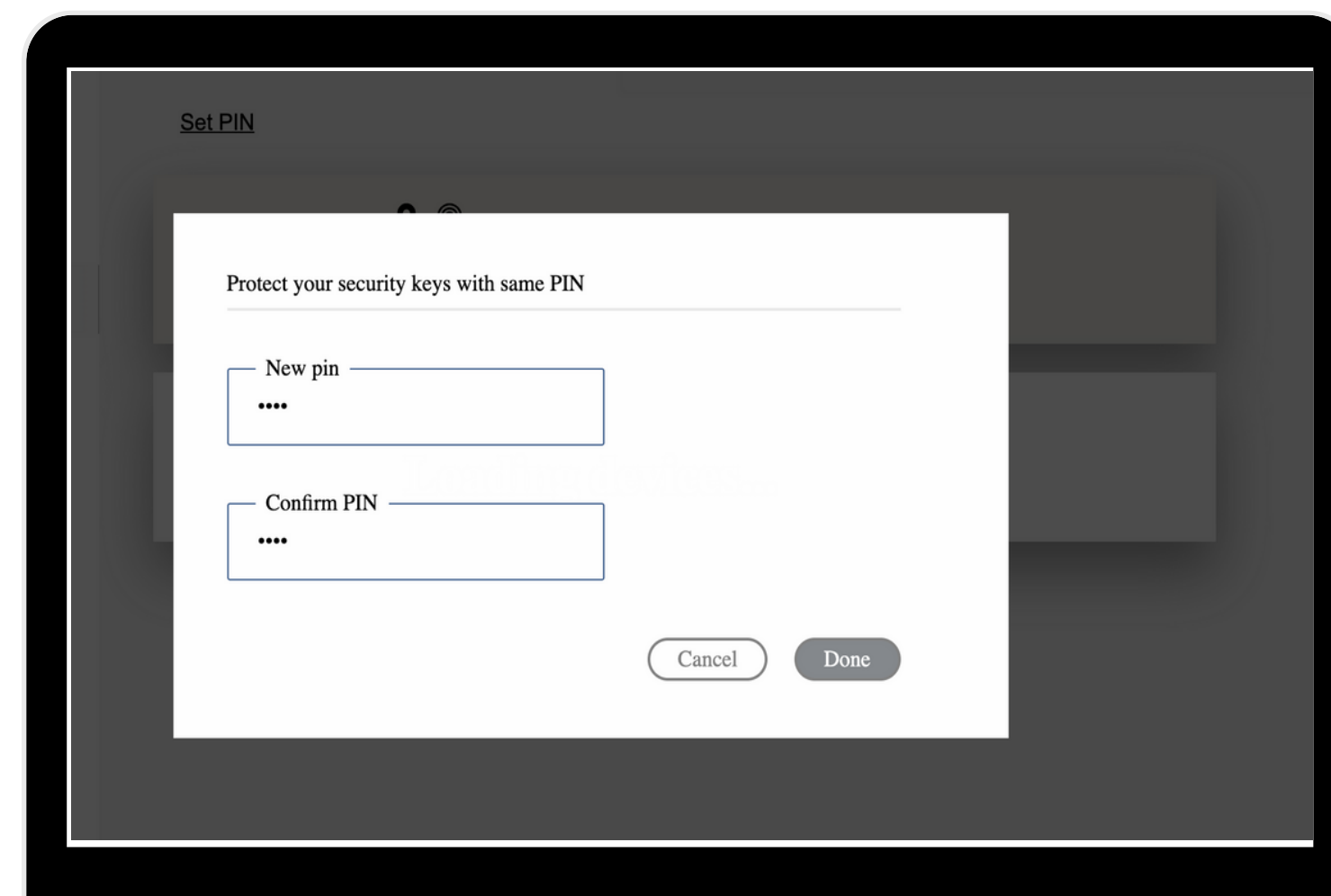
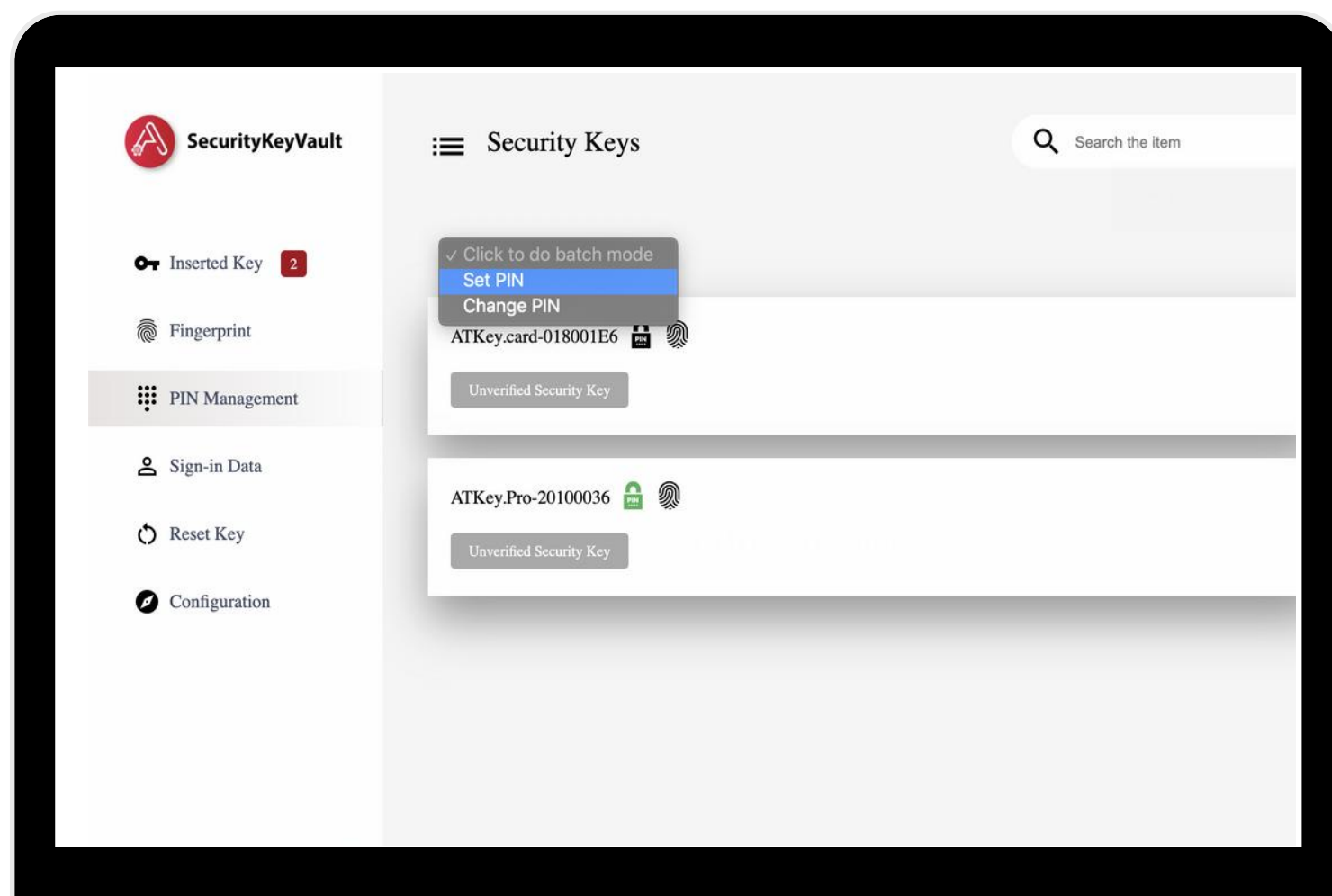

3

PIN Management - Change PIN for batch security keys

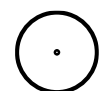

Click to do batch mode → Change PIN

To change the PIN of all security keys simultaneously, please insert all the devices with the same old PIN. If one of them has a different PIN, the card will be shown in red at the end.

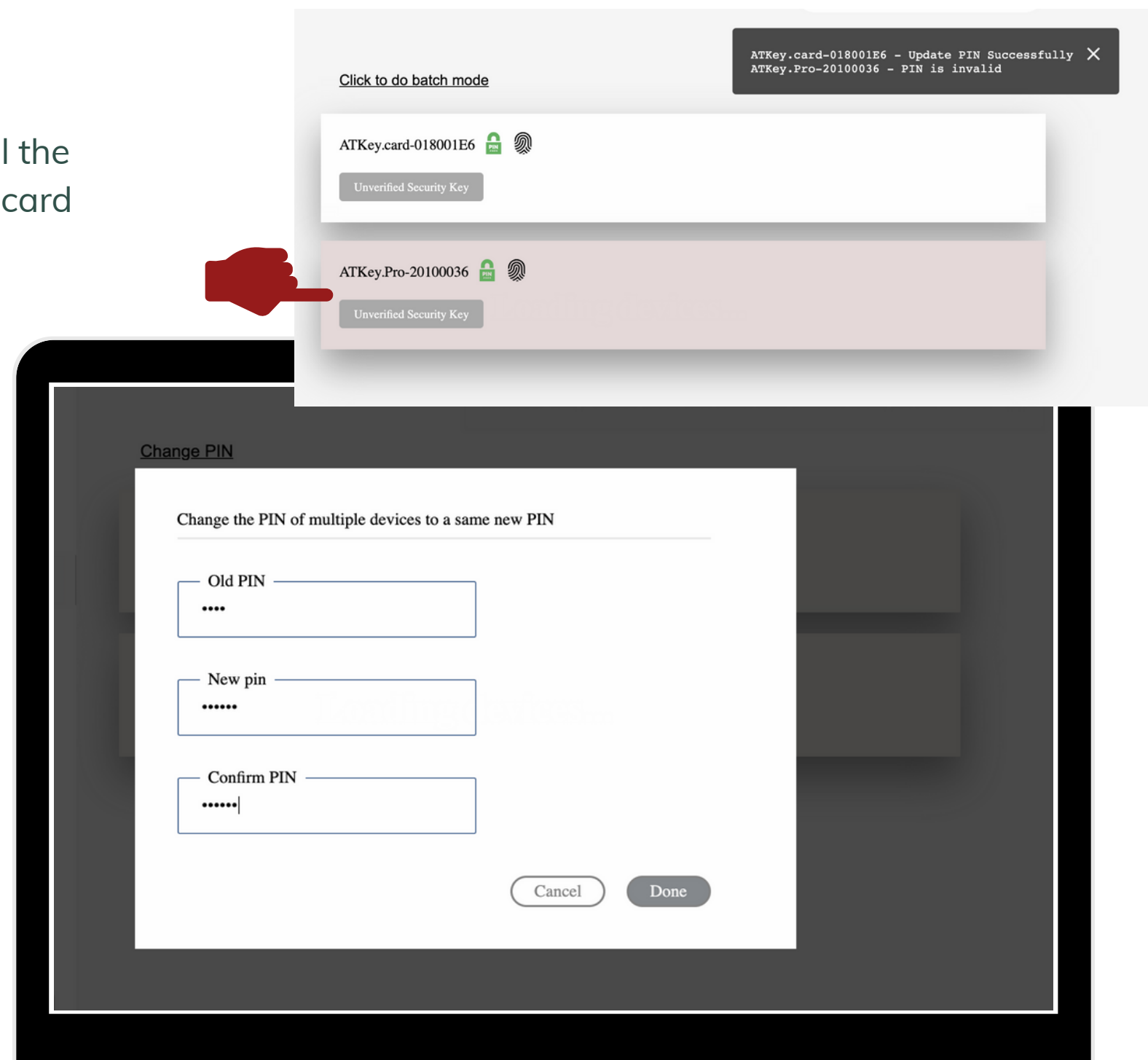
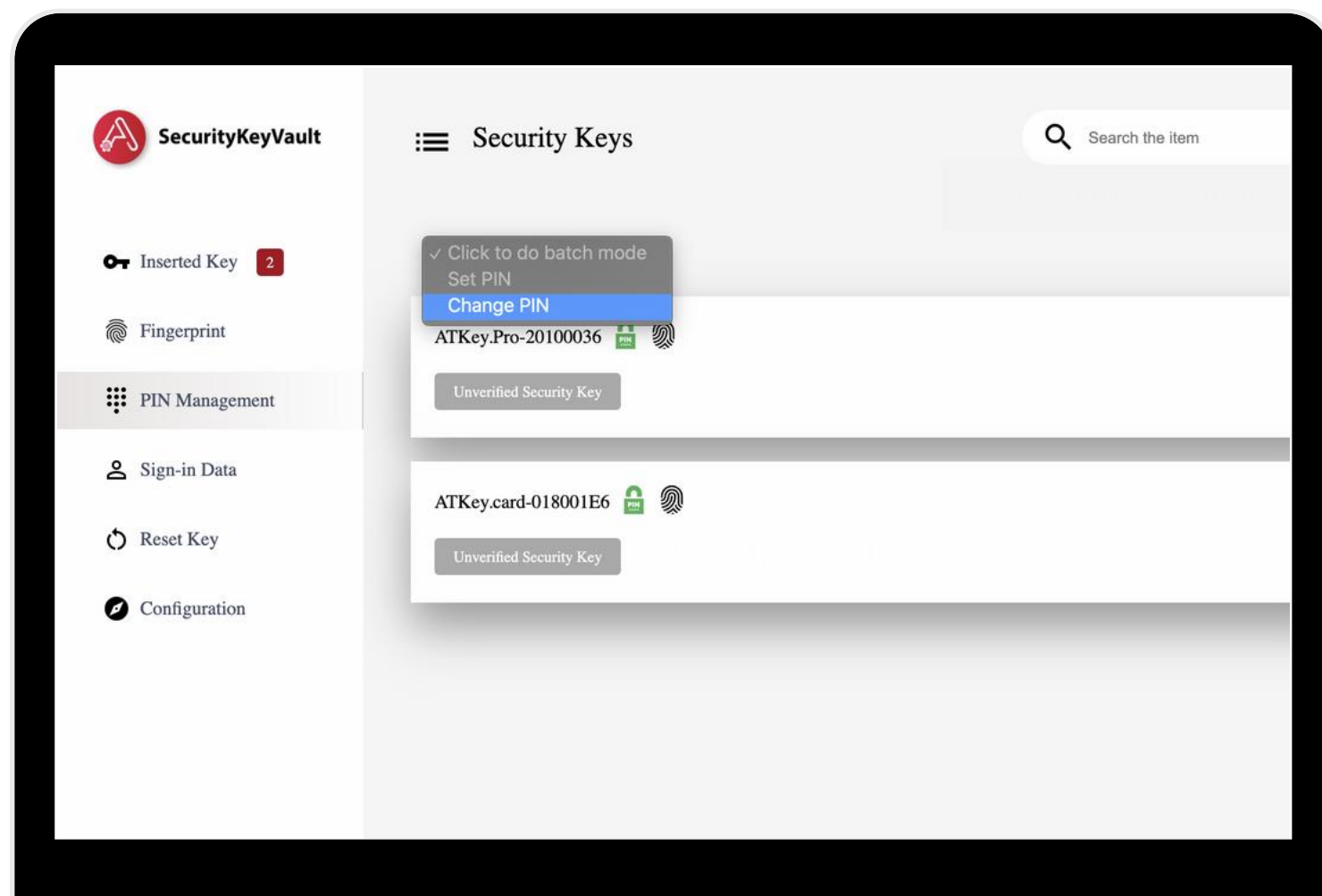

4 Sign-in Data

Delete Sign-in Data

You can check which website and service logins are available for this security key. You can also delete the sign-in data on this page.

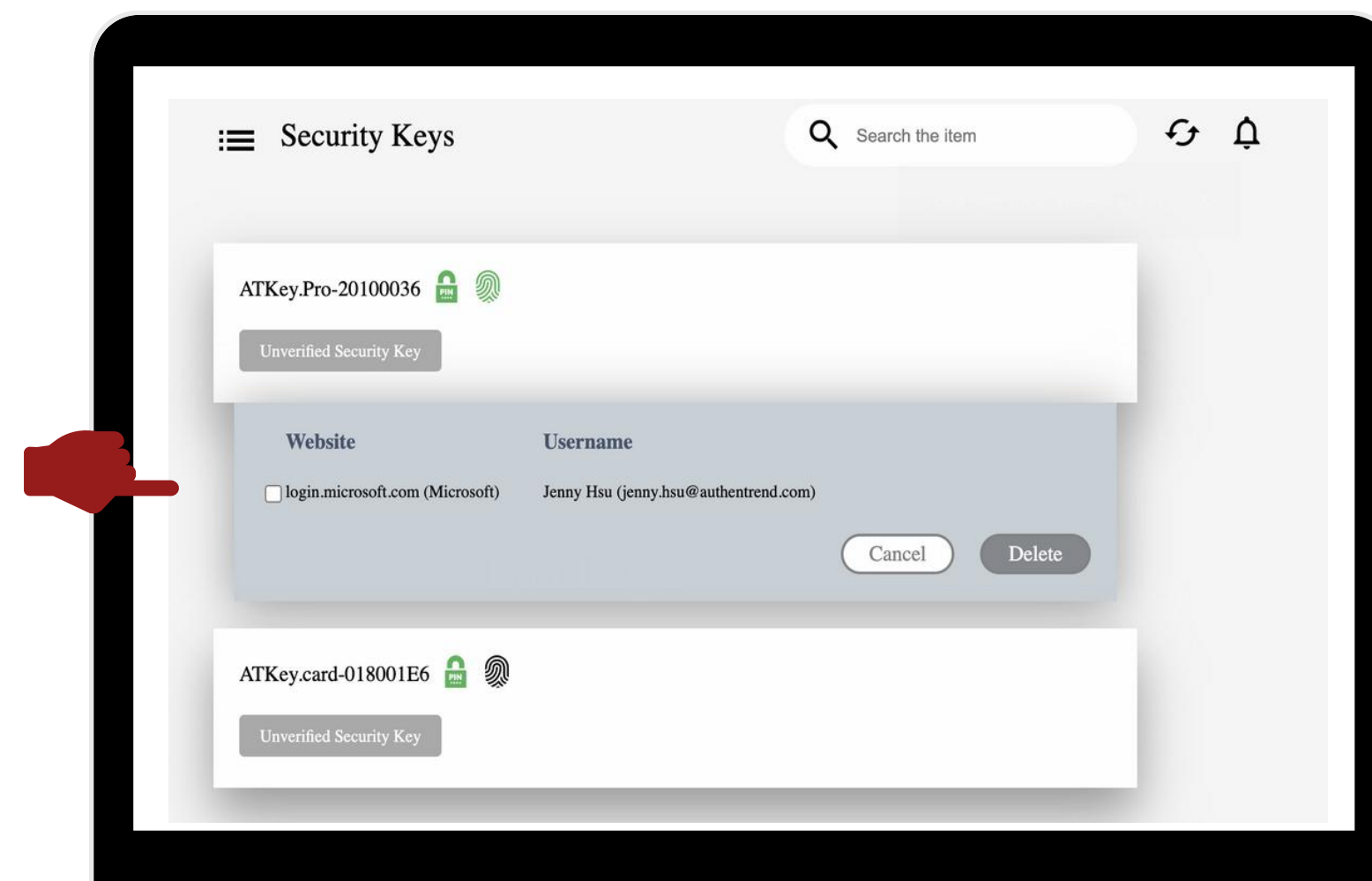
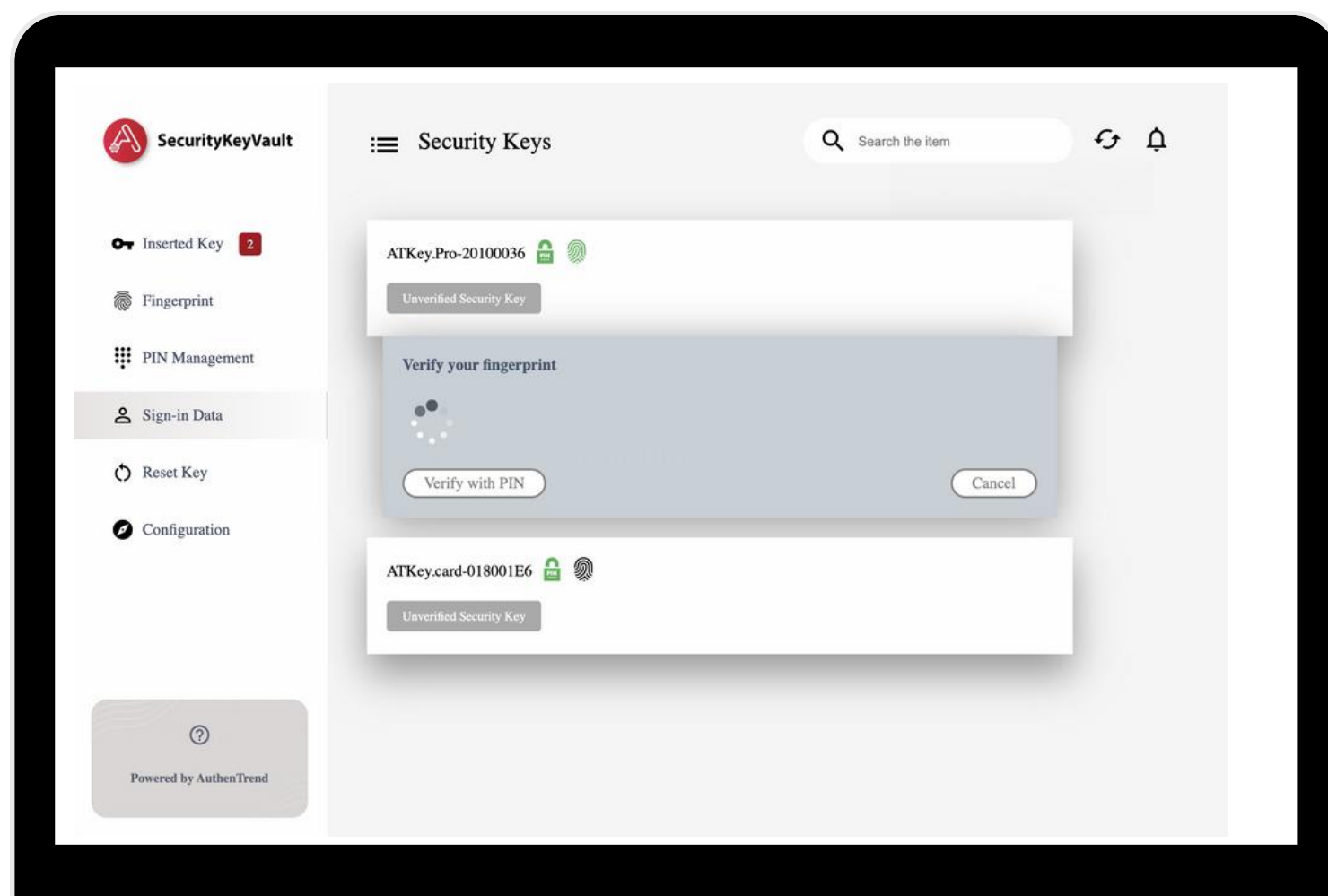

5 Reset Key

- Remove your security key and reinsert it quickly

Touch the sensor on your blinking security key.

- You can reset multiple security keys repeatedly with the same action.



6 Configuration

- Configuration is a feature designed according to the latest FIDO2 spec. If you are using ATKey.Pro, please make sure your device's firmware is the **version 1.00.13. or later versions**. If you are using ATKey.Card, please make sure your device firmware is the version **3.00.1F.39 or later versions**.

- Click the key to select the security keys
The item on the right will show the current setting of this security key. If you select multiple keys, only the status of the first key will be displayed.

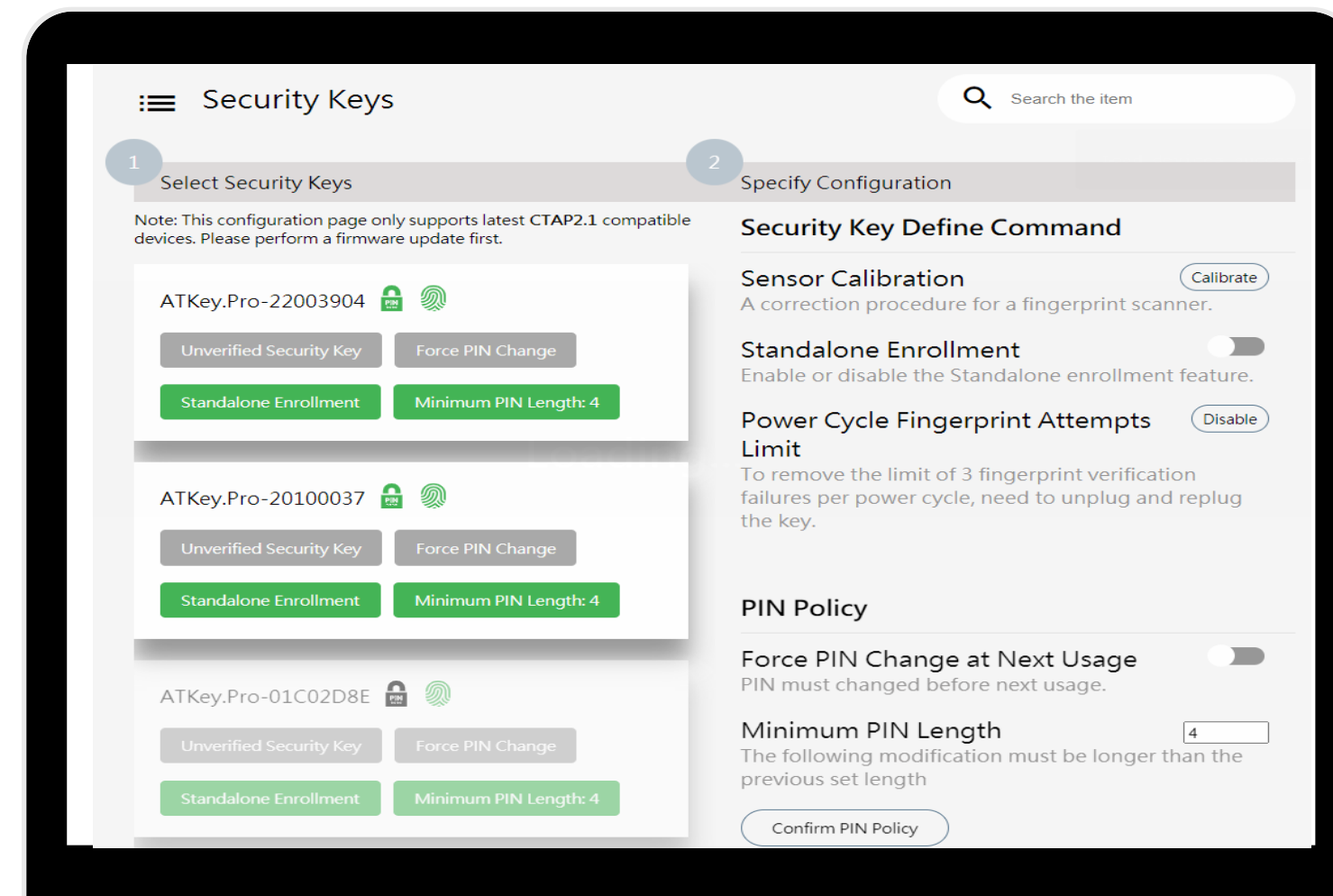
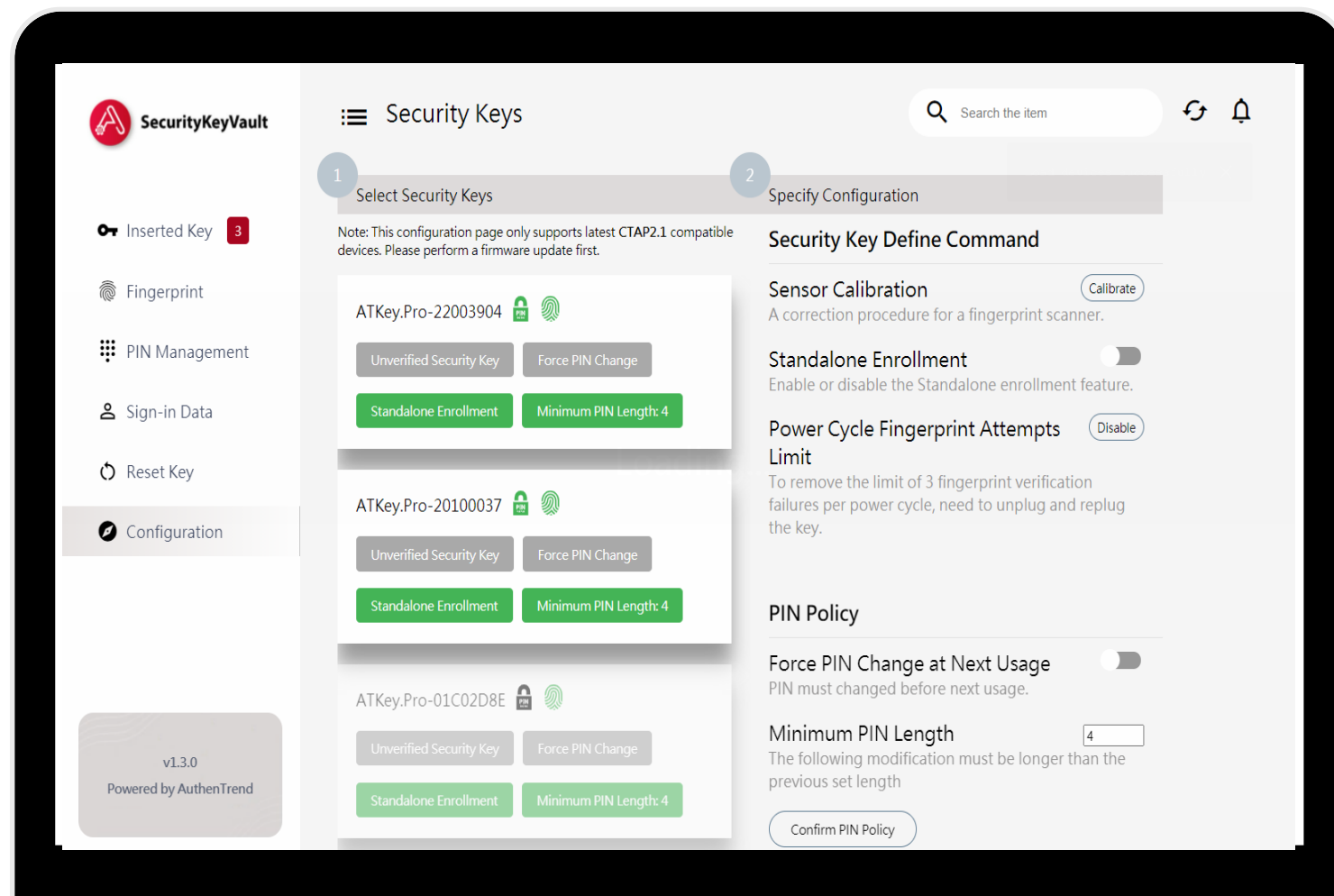

6

Configuration - Security Key Define Command

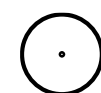

Sensor Calibration: A calibration and correction procedure for the fingerprint scanner.

You can also select multiple keys for simultaneous calibration.

During the calibration, user can't touch the fingerprint sensor (when LED is red)!!

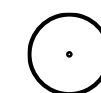

Standalone Enrollment

The default ATKey has Standalone Enrollment feature, which you can disable here.

Note: If you turn off Standalone Enrollment, ATKey can only access the settings of "Fingerprint" and "Sign-in Data" by the PIN.



Standalone Enrollment: No additional software or app is required. Users can easily enroll their fingerprint right on the USB hardware itself.

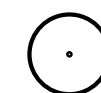

Power Cycle Fingerprint Attempts limit (v1.3.0+)

we have lock mechanism – continuous 3 times failure, key will be locked (LED is red), user can remove-n-plug USB port to try again, total 5 cycles; after it, using PIN to unlock or just reset key.

In some cases, 3 times failure may be not enough, Admin can disable it from here, then it will allow continuous 15 times failure, then lock the key; after it, using PIN to unlock or just reset key.

*** This feature is available from v1.3.0.*

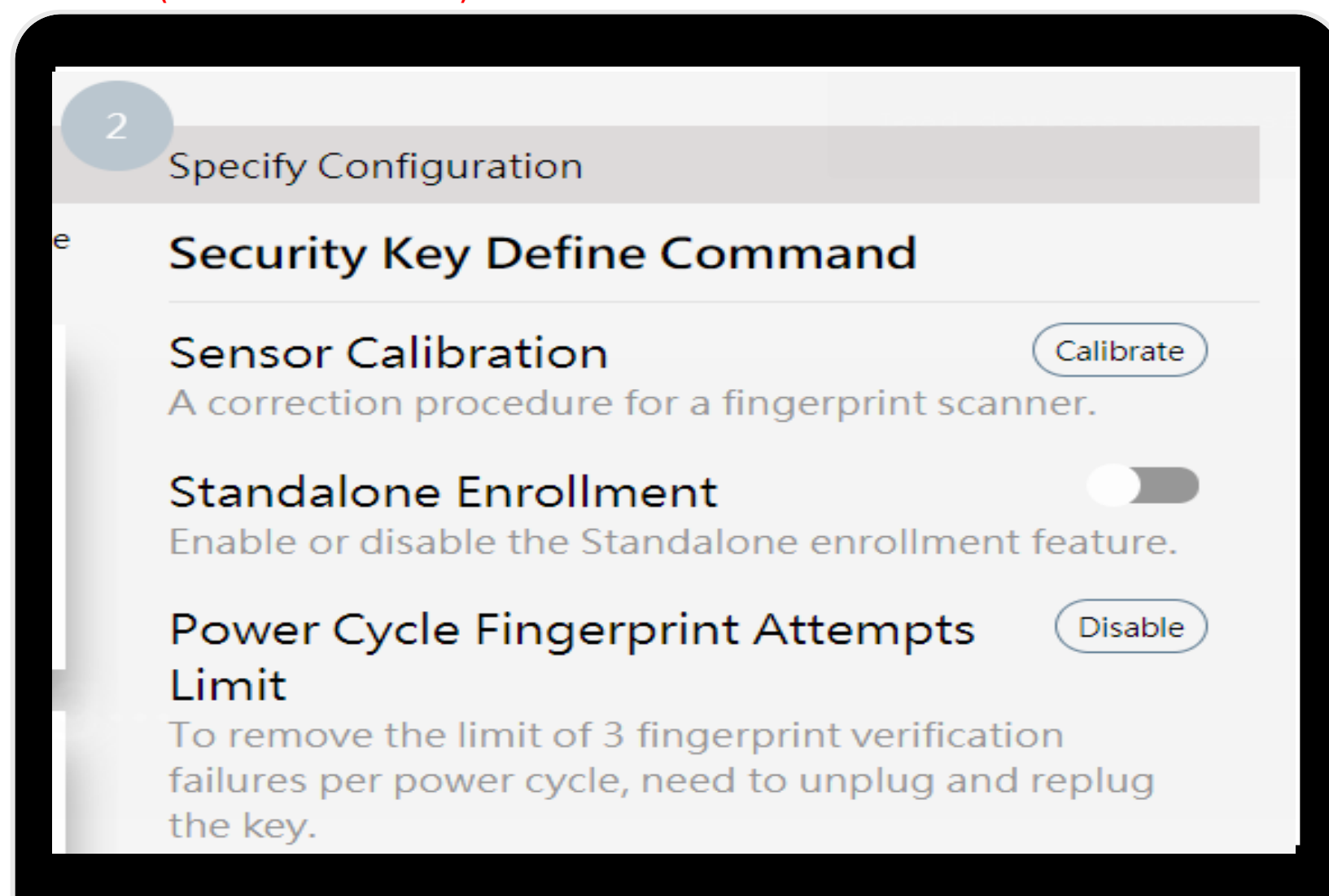

6

Configuration - PIN Policy

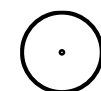

Force PIN Change at Next Usage

Force the user to change the PIN before using the security key next time.

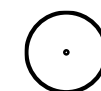

Minimum PIN Length

1. You can set the minimum number of characters for the PIN of the security key. The minimum PIN length can only be increased and cannot be modified downwards. If you want to change multiple keys in a batch, remember that the same PIN is required for you to change these configurations simultaneously.

2. After setting the Minimum PIN Length, "Force PIN Change" will be turned on automatically. Please change the PIN before using it next time.

3. For PIN Policy setting, remember to click confirm to verify the PIN before completing.

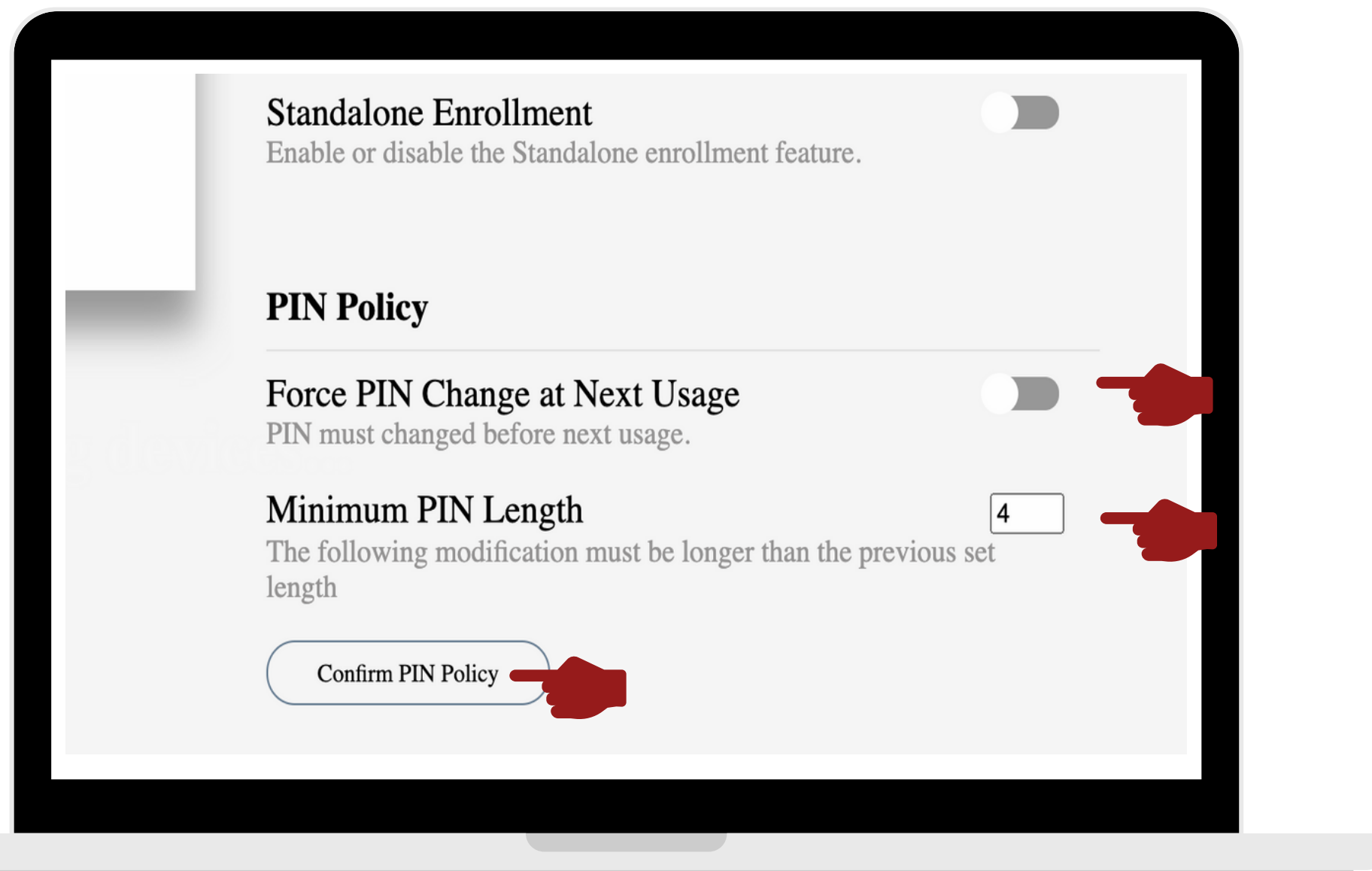

Questions?
Let us know!



www.authentrend.com



contact@authentrend.com